

Series

**FX**



**PACMACHINERY**  
*Maquinaria al cuidado del Medio Ambiente*



RECYCLING SYSTEMS

# rotary shearing machines



**superior in the treatment of scrap metals**

# INNOVATIVE SOLUTIONS

**FX series rotary shearing machines** are designed and constructed to process metallic scraps. The special 4-motor settings (2 per shaft), the exclusive special steel interchangeable blade system and sturdy frame ensure excellent work standards with reduced maintenance time. The low rpm generates high torque to process even very difficult materials.



High thick steel frame

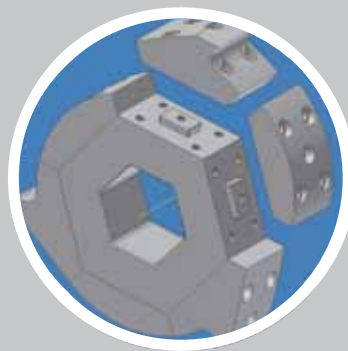

Interchangeable blades  
in special hot forged steel



Bearings outside  
the cutting chamber

## The advantages of Forrec rotary shearing machines FX

- High thick steel frame with minimum number of welding points.
- Each shaft is equipped with two gearboxes and two motors to guarantee high machine performance .
- Gearbox and motor protective carpentry.
- High torque combined with low rpm to cut harder materials.
- Removable blade carriage shafts without blades removal for faster maintenance.
- Special steel shafts with surface heat hardening to drastically reduce wear.
- Hydraulic transmission with constant power regulation system to obtain high cutting torque at low electrical power.
- Blades in hot forged special steel, for mechanical resistance combined with high hardness.
- Interchangeable sector blades with adjustable thickness and number of teeth.
- Independent spacers with hexagonal hole not welded to the blades for easy sharpening.
- Bearings outside the cutting chamber to avoid damages due to material projection.
- Customisable hopper and support structure.
- Built-in modem for fast remote diagnostics.
- Automatic lubrication system controlled by PLC.
- Stop and reverse system for non-shreddable material controlled by PLC.

### *Wide range of available options such as:*

- Two-directional hydraulic powered chute
- Connections with rigid steel tubes
- Conveyor belts
- Remote control
- Hydraulic oil heating for winter operations
- Video cameras
- Load photocells
- Misting systems





Automatic lubrication system



Built-in modem for fast diagnostics



Heat hardening of the shafts



Sophisticated hydraulic system

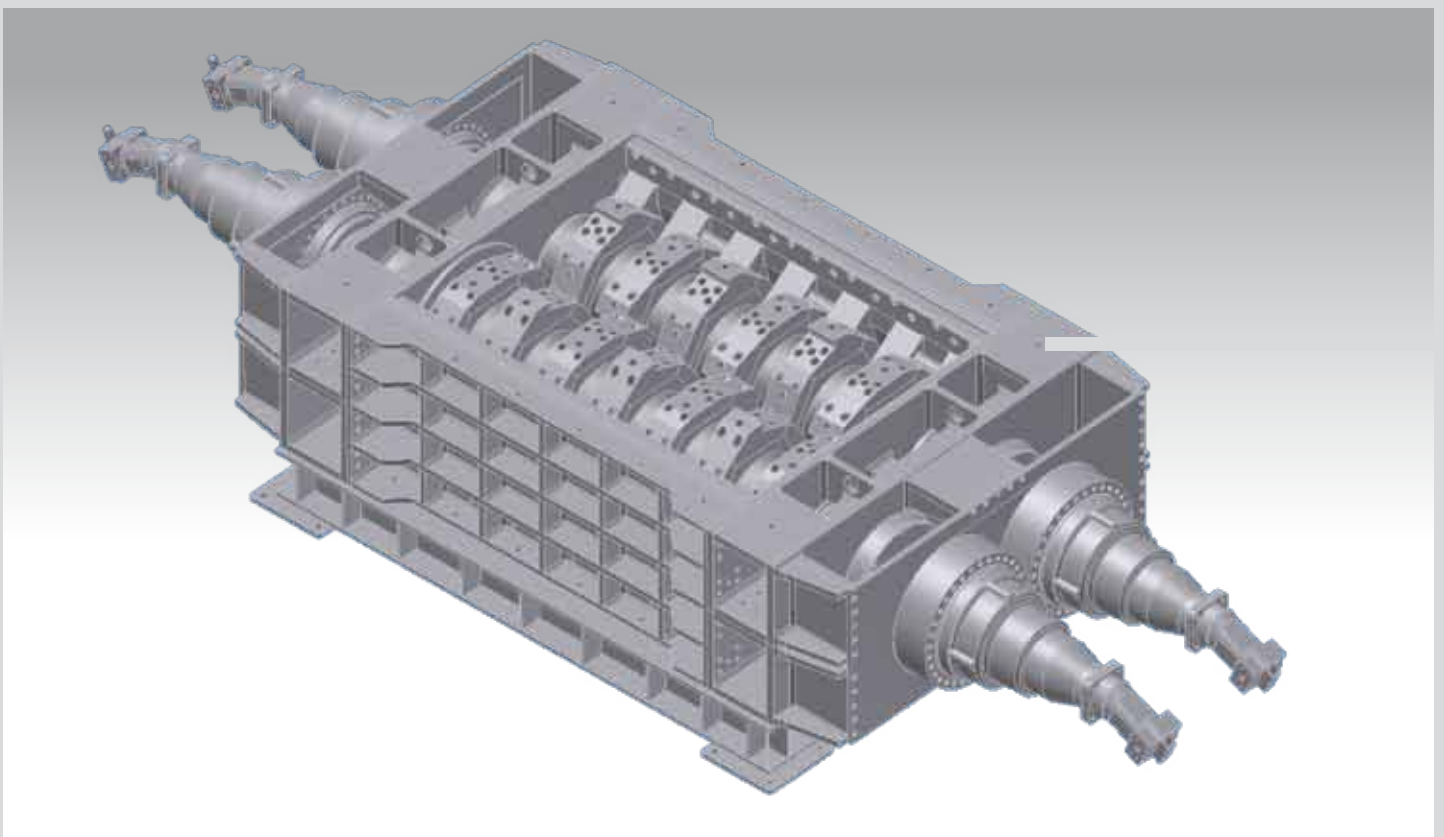

## > Technical specifications

Model		Hydraulic transmission		DIESEL motor	
		FX 5000	FX 8000	FX 5000	FX 8000
Machine width (*)	mm	2100	2400	2100	2400
Machine length (*)	mm	6000	7100	6000	7100
Machine height (*)	mm	850	1100	850	1100
Cutting chamber width	mm	1500	1850	1500	1850
Cutting chamber length	mm	2000	2300	2000	2300
Sectors blades thickness	mm	150 200	200	150 200	200
Weight (*)	ton	25	45	25	45
Installed power	kW	4x90	4x110 - 4x200	500 HP	800 HP
Main control panel controls	Pushbutton panel with lighted signals PLC controlled automations, integrations, emergencies, etc. Control instruments 24 V AC power line				

(\*) Hopper and support frame excluded. Dimensions customizable.

## > Main applications and indicative productivity

		Hydraulic transmission		DIESEL motor	
		FX5000	FX8000	FX5000	FX8000
Unpackaged scrap metals	ton/h	20	40	20	40
Packaged scrap metals	ton/h	12	20	12	20
Demolished cars	ton/h	25	30	25	30
Packaged demolished cars	ton/h	12	20	12	20
<i>Other applications upon request</i>					

Technical alterations reserved.

follow us on

